

Evaluating stress intensity factors due to weld residual stresses by the weight function and finite element methods

Rui Bao^a, Xiang Zhang^{b,*}, Norvahida Ahmad Yahaya^b

^a Institute of Solid Mechanics, School of Aeronautic Science and Engineering, Beihang University, Beijing 100191, China

^b Department of Aerospace Engineering, School of Engineering, Cranfield University, Bedford MK43 0AL, UK

ARTICLE INFO

Article history:

Received 2 November 2009
Received in revised form 6 May 2010
Accepted 2 June 2010
Available online 17 June 2010

Keywords:

Welded joints
Residual stresses
Stress intensity factor
Finite element analysis
Weight function

ABSTRACT

This paper presents a study on the application of the weight function and finite element methods to evaluate residual stress intensity factors in welded test samples. Three specimen geometries and various residual stress profiles were studied. Comparisons of the two different methods were made in terms of the accuracy, easiness to use, conditions and limitations. Calculated residual stress intensity factors by the two different methods are in general in good agreement for all the configurations studied. Computational issues involved in executing these methods are discussed. Some practical issues are also addressed, e.g. treatment of incomplete or limited residual stress measurements, influence of transverse residual stresses, and modelling residual stress in short-length specimens. The finite element method is validated by well-established weight functions and thus can be applied to complex geometries following the procedures recommended in this paper.

© 2010 Elsevier Ltd. All rights reserved.

1. Introduction

Since the adoption of modern welding techniques for manufacturing aerospace structures, evaluation of crack tip stress intensity factors (SIF) resulting from welding induced residual stresses has become an indispensable part to the damage tolerance analysis. This so-called residual stress intensity factor (K_{res}) is required in the prediction of fatigue crack growth rates as well as in the residual strength calculations [1–6]. Current analysis methods are based on the superposition rule of linear elastic fracture mechanics (LEFM). One popular engineering method is to determine the effective stress intensity factor ratio (R_{eff}) to account for the residuals stress effect [1,2]. An alternative method is based on the crack closure concept originally proposed by Elber [7] by calculating the effective stress intensity factor range (ΔK_{eff}) in a combined stress field of the applied and residual. The validity of both methods has been generally accepted. Both R_{eff} and ΔK_{eff} are determined by calculating the K_{res} and using the superposition method [2–4,8]. Therefore, the key task is to evaluate the K_{res} .

The weight function method (WFM) and the finite element method (FEM) have been widely employed for calculating SIFs. The former has been successfully used by many researchers for welded test samples [1,5,9]. Closed-form or approximate analytical solutions are available for calculating the K_{res} and, in general, the solutions are exact or accurate enough. However, most weight functions were developed for simple geometries or require finite width correction. Some weight functions are in very complicated forms that the calculation process involves solving complex integral equations. On the other hand, the FEM is a more robust and versatile tool for complex geometries and loading conditions. It has been successfully used in the fracture analysis in welds [3,10,11]. This method is getting more popular owing to the rapid development of fast computers and

* Corresponding author. Tel.: +44 1234 754621; fax: +44 1234 758203.
E-mail address: xiang.zhang@cranfield.ac.uk (X. Zhang).

Nomenclature

a	half or full crack length in centre crack or edge crack geometry
E, G	Young's modulus, Shear modulus
E'	effective Young's modulus, E for plane stress or $E/(1 - \nu^2)$ for plane strain
$h(a, x)$	weight function
K, K_I	stress intensity factors (SIF), SIF for Mode I crack
$K_{app}, K_{res}, K_{tot}$	SIF due to applied, residual and combined stress fields
W	half width of plate with centre crack, width of plate with edge crack
κ	$\kappa = (3 - \nu)/(1 + \nu)$ for plane stress or $(3 - 4\nu)$ for plane strain
ν	Poisson's ratio

implementation of fracture mechanics analysis routines in the commercial FE packages. The most important case is that welded structural components are usually in complex geometry for which FEM is more powerful than WFM in evaluating the effect of residual stresses on crack tip stress field. However, although the FEM is used in many studies of K_{res} for many years and one recent study has shown good agreement with WFM calculated K_{res} for the mid-crack tension geometry [11], the FEM delivered K_{res} solutions are yet to be validated for further application to complex structural configurations and/or residual stress distributions. There are a few aspects that need to be explored to make sure the FE results are correct or acceptable.

The objectives of this paper are to validate the FEM by the well-established WFM for simple geometries and to establish good practices and procedures for application of FEM to complex welded structures. The available weight functions and their application in residual stress field are summarized firstly. Then, the procedure of evaluating K_{res} via FEM is described. Discussion is made for the aspects of introducing residual stresses into FE model, dealing with incomplete measured residual stresses and effect of transverse residual stresses. The study cases include three specimen configurations and various residual stress profiles resulting from two welding processes and different crack positions. Comparisons of the two different methods are performed in terms of their accuracy, easiness for the users, and application scope and conditions. Computational issues and influential factors in these two methods are also discussed.

2. Weight function method in residual stress field

2.1. The concept

Two-dimensional plane stress or plane strain problems of a crack length a in an infinite body subjected to an arbitrary symmetrical loading can be solved provided that certain results are known for one symmetrical loading, i.e. displacement of the crack faces, $v^{(1)}(a, x)$, and the stress intensity factor, $K_I^{(1)}$ [12]. The SIF for any other symmetrical loading at the crack tip $x = a$ is given by

$$K_I = \int_0^a \sigma(x)h(a, x)dx \quad (1)$$

where $\sigma(x)$ is the stress over the crack site in an un-cracked body, $h(a, x)$ the weight function that is independent of $\sigma(x)$.

$$h(a, x) = \frac{8G}{1 + \kappa} \frac{1}{K_I^{(1)}} \frac{\partial v^{(1)}}{\partial a} \quad (2)$$

The Green's function is an earlier approach that is similar to the weight function method [13]. In order to apply the method, it is necessary to know the appropriate Green's function and the distribution of stress along the crack site in the un-cracked solid. Once these are known, the technique will give exact solutions. Often this may not be available and it is then necessary to make approximations [12]. For the case of a two-dimensional problem of a cracked sheet containing a crack of length $2a$ subjected to localized forces $\pm P$ acting at points on the crack surface and normal to the crack faces, the SIF is calculated by:

$$K_I = \frac{P}{\sqrt{\pi a}} \left(\frac{a+x}{a-x} \right)^{\frac{1}{2}} \equiv \frac{P}{\sqrt{\pi a}} G(x) \quad (3)$$

If a pressure, $p(x)$, acts normal to the crack faces, $-a \leq x \leq a$, then

$$K_I = \frac{1}{\sqrt{\pi a}} \int_{-a}^a p(x)G(x)dx = \int_{-a}^a p(x) \frac{1}{\sqrt{\pi a}} G(x)dx = \int_{-a}^a p(x)g(a, x)dx \quad (4)$$

The Green's function, $G(x)$, for this particular problem is:

$$g(a, x) = \frac{1}{\sqrt{\pi a}} G(x) = \frac{1}{\sqrt{\pi a}} \sqrt{\frac{a+x}{a-x}} \quad (5)$$

Eq. (4) is consistent to Eq. (1) in form.

In the following sections, both weight functions and Green's functions are expressed as $h(a, x)$, and the stresses acting on the crack-free body are expressed by $\sigma(x)$.

In order to apply the WFM to calculate the SIF resulting from weld thermal residual stresses, it is necessary to know $\sigma(x)$ and $h(a, x)$. The residual stress distributions, $\sigma(x)$, can be obtained by either experimental measurements [14,15], e.g. the diffraction methods, the hole drilling, and the cut-compliance method, or the inverse method from crack growth rate data [16], or via thermal stress analysis of welding process. The availability of $\sigma(x)$ is the prerequisite of both the WFM and FEM.

The WFM should give exact solution providing that the correct $h(a, x)$ is used. Many different weight functions of either closed-form or approximate are available for simple configurations, i.e. centre crack and edge crack(s) [17].

2.2. Available weight functions for simple configurations

Although the distributions of weld residual stresses always manifest different characteristics and profiles due to the different welding processes, from the numerical integration method point of view, load acting on the crack length interval Δa can be treated as point load when Δa is infinitesimal. So, all the weight functions, including the approximate forms, developed for the point load can be applied for calculating SIF due to distributed residual stress.

2.2.1. Weight functions for an infinite sheet

Green's function, Eqs. (4) and (5), is the simplest form of weight function for an infinite sheet with centre crack of length $2a$, Fig. 1a, [18,19]. For edge crack in a semi-infinite sheet, Fig. 1b, Sih [20] used the approximate form of weight function expressed by Eq. (6).

$$h(a, x) = \frac{1}{\sqrt{\pi a(1 - (x/a)^2)}} \left[1.3 - 0.3(x/a)^5 \right] \quad (6)$$

2.2.2. Weight functions for finite width sheet

Several weight functions are developed for the simple configurations of finite width with a centre or edge crack as shown in Fig. 2.

Tada et al. [19] developed a weight function expressed by Eq. (7) for finite width, infinite length sheet with centre crack subjected symmetrical point loads as shown in Fig. 2a. Tada stated that this weight function should give better accuracy if $a/W < 0.5$

$$h(a, x) = \frac{2}{\sqrt{2W}} \left\{ 1 + 0.297 \sqrt{1 - \left(\frac{x}{a}\right)^2} \left[1 - \cos\left(\frac{\pi a}{2W}\right) \right] \right\} \sqrt{\tan\left(\frac{\pi a}{2W}\right)} \left\{ 1 - \left[\frac{\cos\left(\frac{\pi a}{2W}\right)}{\cos\left(\frac{\pi x}{2W}\right)} \right]^2 \right\}^{-\frac{1}{2}} \quad (7)$$

Wu and Carlsson [17] derived Eq. (8) for a centre crack in a finite rectangular plate, Fig. 2b. For the special cases of $H/W \geq 2.0$, Eq. (9) can be used to determine the simple expressions for the $\beta_i(a/W)$ functions (within 1% for the weight function for $a/W \leq 0.5$).

$$h(a, x) = \frac{1}{\sqrt{\pi a}} \sum_{i=1}^3 \beta_i\left(\frac{a}{W}\right) \left[1 - \left(\frac{x}{a}\right)^2 \right]^{i-\frac{3}{2}} \quad (8)$$

$$\beta_1(a/W) = 2.0$$

$$\beta_2(a/W) = \frac{\pi a}{2W} \tan\left(\frac{\pi a}{2W}\right)$$

$$\beta_3(a/W) = 0$$

(9)

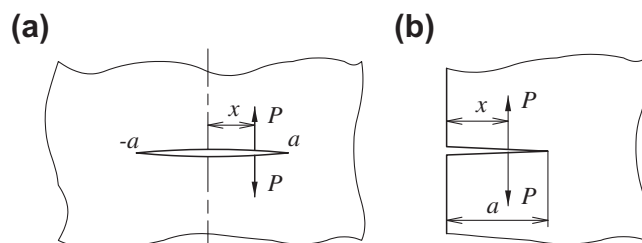

Fig. 1. Configurations of infinite sheet with centre (a) and edge crack (b).

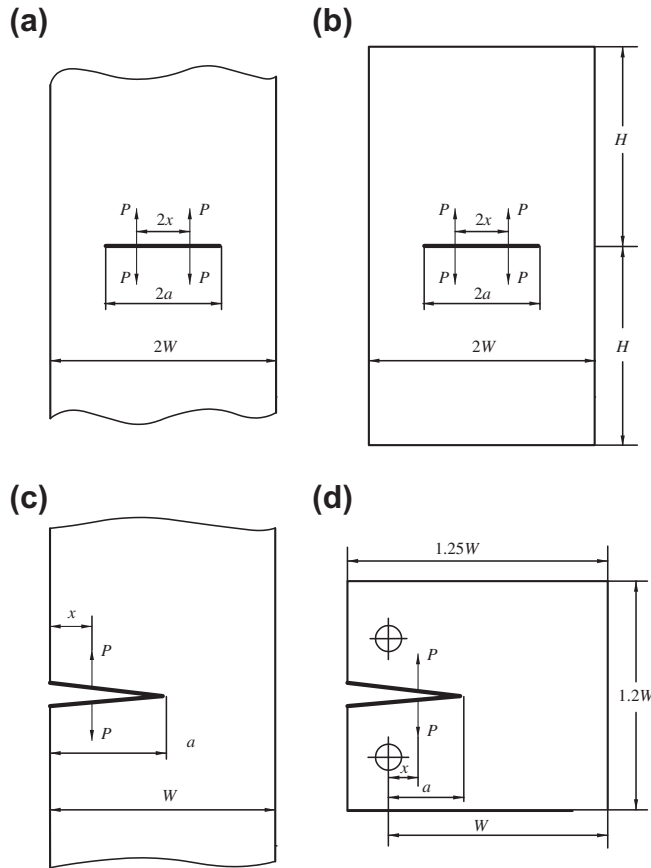

Fig. 2. Configuration of finite width sheet with a center or edge crack: (a) infinite length center crack; (b) finite length center crack; (c) infinite length edge crack; and (d) finite length edge crack.

The weight functions for infinite sheet, i.e. Green’s function in Eq. (5) and Sih’s function in Eq. (6), etc., can also be applied to finite width when multiplying a correction function, such as the Isida’s finite width correction function [21].

A weight function for single edge crack in a finite width but infinite length sheet, Fig. 2c, was firstly developed by Bueckner [22], Eq. (10).

$$h(a, x) = \frac{2}{\sqrt{2\pi(a-x)}} \left[1 + m_1 \left(\frac{a-x}{a} \right) + m_2 \left(\frac{a-x}{a} \right)^2 \right] \tag{10}$$

where

$$\begin{aligned} m_1 &= 0.6147 + 17.1844 \left(\frac{a}{W} \right)^2 + 8.7822 \left(\frac{a}{W} \right)^6 \\ m_2 &= 0.2502 + 3.2889 \left(\frac{a}{W} \right)^2 + 70.0444 \left(\frac{a}{W} \right)^6 \end{aligned} \tag{11}$$

Kaya and Erdogan [23] also presented a weight function for such geometry, Eq. (12), where $g_i(a/W)$, $i = 1, 2, 3, 4$, can be found in [23] and are listed in Appendix A.

$$h(a, x) = \frac{2}{\sqrt{\pi a}} \frac{g_1 \left(\frac{a}{W} \right) + g_2 \left(\frac{a}{W} \right) \frac{x}{a} + g_3 \left(\frac{a}{W} \right) \left(\frac{x}{a} \right)^2 + g_4 \left(\frac{a}{W} \right) \left(\frac{x}{a} \right)^3}{\left(1 - \frac{a}{W} \right)^{\frac{3}{2}} \sqrt{1 - \left(\frac{x}{a} \right)^2}} \tag{12}$$

Wu and Carlsson also presented a weight function for this configuration in [17],

$$h(a, x) = \frac{1}{\sqrt{2\pi a}} \sum_{i=1}^5 \beta_i \left(\frac{a}{W} \right) \left[1 - \left(\frac{x}{a} \right) \right]^{i-\frac{3}{2}} \tag{13}$$

where $\beta_i(a/W)$ is much more complicated than that in Eqs. (8) and (9), and can be expressed by several equations [17]. For simplification in application, Wu and Carlsson provided some discrete values of $\beta_i(a/W)$ for selected non-dimensional crack lengths which are listed in Appendix A, Table A1.

If the edge crack is in a plate of finite width and length as shown Fig. 2d, e.g. the compact tension, C(T), then the effect of sample's length on the SIF must be taken into account by choosing a suitable weight function.

Fett and Munz [24] developed a weight function for the C(T) geometry, Eq. (14), by using the fundamental principle of Petroski and Achenbach [25].

$$h(a, x) = \sqrt{\frac{2}{\pi a}} \frac{1}{\sqrt{1 - \frac{x}{a}}} \left[1 + \sum_v^{\mu} \frac{A_{v,\mu} \left(\frac{a}{W}\right)^{\mu}}{\left(1 - \frac{a}{W}\right)^{\frac{3}{2}}} \left(1 - \frac{x}{a}\right)^{v+1} \right] \quad (14)$$

where $A_{v,\mu}$ are the weight function coefficients and listed in Appendix A, Table A2.

Wu and Carlsson [17] also proposed a weight function for the C(T) geometry, Eq. (15).

$$h(a, x) = \frac{1}{\sqrt{2\pi a}} \sum_{i=1}^4 \beta_i \left(\frac{a}{W}\right) \left[1 - \left(\frac{x}{a}\right)\right]^{i-\frac{3}{2}} \quad (15)$$

where $\beta_i(a/W)$ are different from those in Eqs. (8) and (13). The discrete values of $\beta_i(a/W)$ for selected non-dimensional crack lengths are listed in Appendix A, Table A3.

2.2.3. Other weight functions

Beghini and Bertini [26,27] developed weight functions for inclined cracks at sharp V-notches and semi-plane. Weight function for a 3D surface crack is also available [28]. For other configurations, such as a centre crack in a circular disc, double edge crack, multiple cracks, etc., corresponding weight functions have been developed by Tada et al. [19], Wu and Carlsson [17], Fett and Munz [24]. Weight functions of general forms were also proposed by Fett et al. [29], and Sha and Yang [30].

2.3. Evaluating SIF due to welding residual stresses by WFM

2.3.1. Available SIF solutions

Various kinds of weight functions have been applied to determine the intensity of the crack tip elastic field for cracks introduced into the residual stress field (including thermal stresses). In the absence of external loads, residual stressed are self-balanced, built-in field, which require no special treatment when using the WFM. The method is based on the superposition principle [19].

There are some closed-form SIF solutions that are deduced by the WFM. Tada et al. [31] presented SIF solutions for various crack-absent residual stress distributions and crack geometries. For example, they used the Green's function to obtain the SIF solution for centre crack in infinite width plate. When the residual stress distribution is expressed by Eq. (16), Fig. 3a, K_I is given by Eq. (17).

$$\sigma(x) = \sigma_0 \cdot e^{-\frac{1}{2}\left(\frac{x}{c}\right)^2} \left[1 - \left(\frac{x}{c}\right)^2\right] \quad (16)$$

$$K_{res} = \sigma_0 \sqrt{\pi a} e^{-0.42\left(\frac{a}{c}\right)^2} \left[1 - \frac{1}{\pi} \left(\frac{a}{c}\right)^2\right] \quad (17)$$

For a finite width rectangular plate, Wu and Carlsson [17] presented the SIF solution according to this stress distribution using their weight function, Eq. (8). Tada's and Wu's solutions are compared in Fig. 3b, which shows that: (1) The SIF results given by Tada and Wu agree with each other very well when the width of the plate is adequate compared with the distribution of residual stress. (2) For inadequate width ratio, e.g. $W/c = 4$, although the stress at the edge is almost zero, the width effect could not be ignored; weight functions with width correction gives more accurate result in this case.

However, weld residual stresses as measured are not always in the single peak form as Fig. 3a and Eq. (16) describe. Most cases need numerical integration of Eq. (1). This will be demonstrated through practical examples in Section 4.

2.3.2. Influence of incomplete residual stress measurement data

Residual stresses should be self-balanced in the absence of external loads. However, during residual stress measurement experiments tensile residual stresses often attract more attention than compressive stresses. Consequently measured stress distribution is often incomplete and dominated by tensile stresses resulting in un-balanced stress field. If the equilibrium condition is not fulfilled, evaluated SIF distribution as a whole is in general meaningless. However, in some cases of engineering failure assessment, attention is on crack propagation in the weld zone. Thus, if the values of K_{res} are correct in region of interest, then the assessment is meaningful. The purpose of the work presented in this section is to understand the effect of incomplete RS on K_{res} if measured residual stresses are available only in the crack growth region.

Two cases are studied: case 1 is centre crack with a longitudinal weld in the middle of plate, Fig. 4a; case 2 is edge crack with longitudinal weld, Fig. 4b. For demonstration purpose, the analytical stress distribution in Eq. (16) is used and

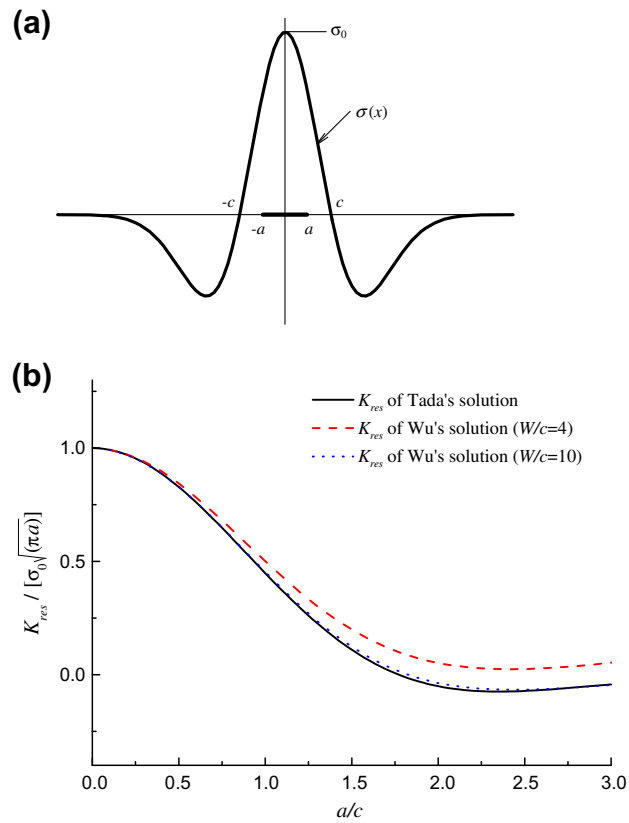

Fig. 3. WF solution of SIF given for a given residual stress field: (a) residual stress distribution and (b) comparison of Tada's and Wu's solutions.

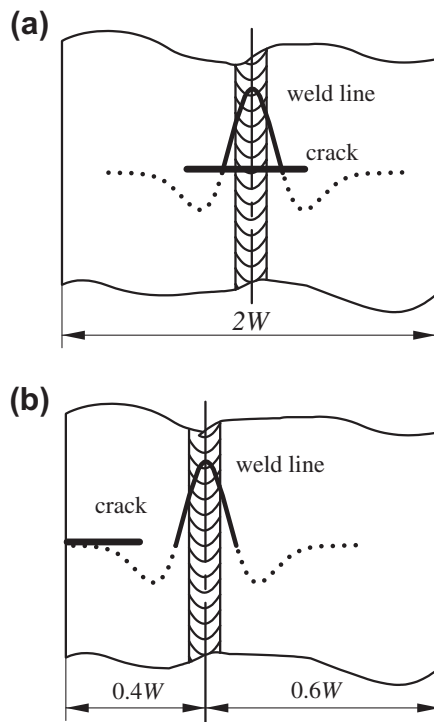

Fig. 4. Balanced and incomplete residual stresses ($W = 10c$) in (a) centre crack and (b) edge crack samples.

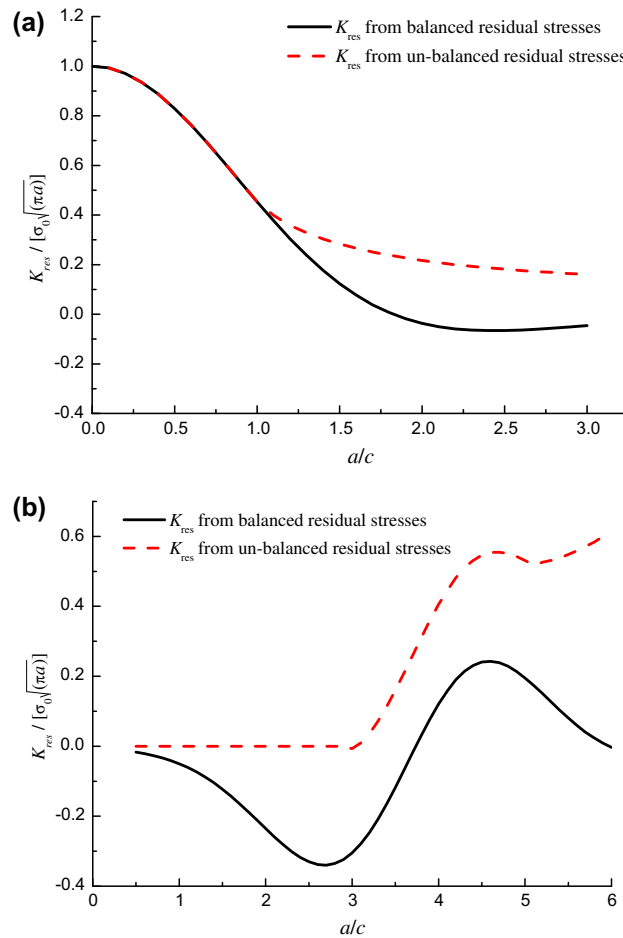

Fig. 5. Influence of incomplete residual stress on SIF: (a) center crack; (b) edge crack.

plotted in Fig. 4; solid and dotted lines form a full and balanced stress field. Assumed un-balanced residual stress is achieved by limiting $\sigma(x)$ to region $-1.1c \leq x \leq 1.1c$ (solid line); stresses outside this region (dotted line) are set to zero. For simplicity and emphasising on the effect of un-balanced stress, effect of sample length is not considered. Wu and Carlsson weight function, Eq. (8), is used for case 1, and Bueckner's weight function, Eq. (10), is used for case 2. Normalized SIF values for case 1 and 2 are shown in Fig. 5a and b, respectively, and compared with those SIF solutions due to balanced stresses. It indicates that: (1) For the centre crack that has the same symmetric axis as the stress distribution, the imbalance of the stresses has no influence on K_{res} while the crack length a is within the boundary of the region where the residual stresses are known. (2) For the edge crack, the result obtained from un-balanced stresses is totally different from that gained by balanced stresses. Therefore, for the edge crack geometry full and balanced residual stress field is necessary for evaluating residual SIF by WFM. In other words, if a crack is completely embedded in the region where the residual stress is evaluated or correctly interpolated and the crack and the residual stress distribution have the same symmetric axis, (e.g. the centre crack case), then partial knowledge of the stress is not a problem when using the WFM. The required function $\sigma(x)$ is enough for obtaining the correct K_{res} , and the stresses in other regions do not affect the result. However, the problem of partial knowledge of residual stresses arises when the WFM is applied to a crack for which residual stress is known only on a portion of the crack length (e.g. an edge crack). In this case application of the WFM needs the residual stress to be reasonably extrapolated on the whole crack domain and the equilibrium condition has to be correctly fulfilled.

3. Finite element method

3.1. Introduction of residual stresses into FE models

For evaluating K_{res} , it is important to input correct initial stress conditions to numerical models to characterise measured residual stresses. The function of defining initial stress condition is available in many commercial FE software packages, e.g.

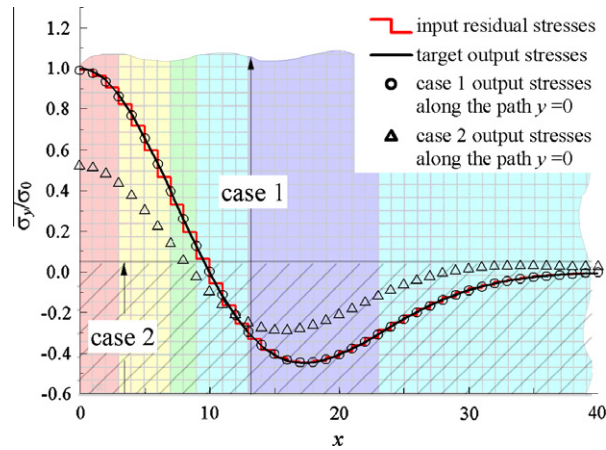

Fig. 6. Input and output of initial stresses.

ABAQUS subroutine SIGINI [32], ANSYS command INISTATE [33]. These initial stresses should be equilibrated in the first analysis step to result in zero stresses in model's free edges and self-equilibrium condition without any constraint. ABAQUS command "UN-BALANCED STRESSES" can be called to do this, while in ANSYS, the initial stress must be applied in the first load step and be equilibrated automatically.

According to the experimental measurements, the profiles of weld residual stresses are almost identical along the y-axis that is parallel to the weld line. Therefore, elements with the same x coordinate should have the same initial stress condition. In other words, if the residual stress distribution is expressed by discrete value σ_i at x_i , ($i = 1, 2, \dots, n$), initial stress $(\sigma_{i-1} + \sigma_i)/2$ should be introduced to all the elements located within (x_{i-1}, x_i) .

To obtain correct K_{res} value, it is necessary to make sure that the resulted stress distribution in the FE model after the equilibrium is in accordance with the measured residual stress field within an acceptable discrepancy. However, it is not always possible to obtain the same output stress field as the input residual stress. For configurations of relatively short length with respect to the width, such as the C(T) geometry, obtained residual stresses are found to be much lower than inputted values after the equilibrium step. This issue was also mentioned in [34].

An example is given here to demonstrate the influence of specimen length. The residual stress distribution follows Eq. (16), letting $c = 10$ mm, and is introduced to the FE model with discrete values over every 1 mm distance. Case 1 has the average residual stress $(\sigma_{i-1} + \sigma_i)/2$ introduced to all the elements located within (x_{i-1}, x_i) , whereas in case 2 residual stresses are only inputted into the elements within $y < 10$ mm (to model a short-length specimen). After the self-equilibrium balance, the resultant residual stresses being kept in the FE model of the case 2 is much lower than the actual input values as shown in Fig. 6.

Therefore, when dealing with the C(T) configuration, the input initial stresses should be increased so that the actual residual stresses in the FE model, after the self-equilibrium step, can match the measured values. In [34], the proportional integral (PI) adjustment, which is widely used in the area of automatic control, was applied to introduce residual stresses into FE models. It is a good way to solve this problem. The adjustment equation is:

$$\sigma(x)_{input}^{j+1} = \sigma(x)_{input}^j + \beta(\sigma(x)_{target} - \sigma(x)_{output}^j) \tag{18}$$

The procedure starts with the adjustment step $j = 0$ and $\sigma(x)_{input} = \sigma(x)_{target}$, and ends when the agreement between $\sigma(x)_{output}$ and $\sigma(x)_{target}$ is satisfied, where $\sigma(x)_{target}$ is the measured residual stress distribution.

Welding process also introduces transverse residual stresses. Although, the magnitude of transverse residual stress is usually much smaller than that of the longitudinal residual stress, introducing transverse residual stress to FE model will affect the magnitude of the longitudinal residual stress after the equilibrium step; consequently, evaluated K_{res} value will be affected. Therefore, it is important to check the output value of the longitudinal residual stress in the FE model to make sure that the residual stresses are introduced correctly.

3.2. Calculating K_{res} by FEM

There are a few methods for evaluating the SIF by FEM, such as the crack tip displacements extrapolation, the J -integral, the strain energy approach, e.g. the virtual crack extension technique. The displacement extrapolation and J -integral methods are widely used practices and implemented in commercial FE software packages. However, the J -integral is no longer path-independent in the presence of thermal strains, path dependent plastic strains, body forces within the integration area, and pressure on the crack surface. Therefore, J -integral method is not suitable for evaluating SIF due to weld thermal residual

stresses. For linear elastic analysis, the displacement extrapolation method is a good choice, which is simple and straightforward to obtain the SIF values based on FE results.

According to the LEFM, the crack tip displacement field in the load direction for a 2D problem is [35]:

$$u_y = \frac{K_I}{2G} \sqrt{\frac{r}{2\pi}} \sin\left(\frac{\theta}{2}\right) \left[\kappa + 1 - 2 \cos^2\left(\frac{\theta}{2}\right) \right] - \frac{K_{II}}{2G} \sqrt{\frac{r}{2\pi}} \cos\left(\frac{\theta}{2}\right) \left[\kappa - 1 - 2 \sin^2\left(\frac{\theta}{2}\right) \right] \quad (19)$$

where u_y, r, θ are defined in crack tip coordinate, Fig. 7.

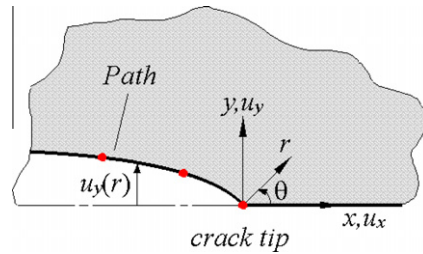

Fig. 7. Coordinate at crack tip and path for displacement extrapolation.

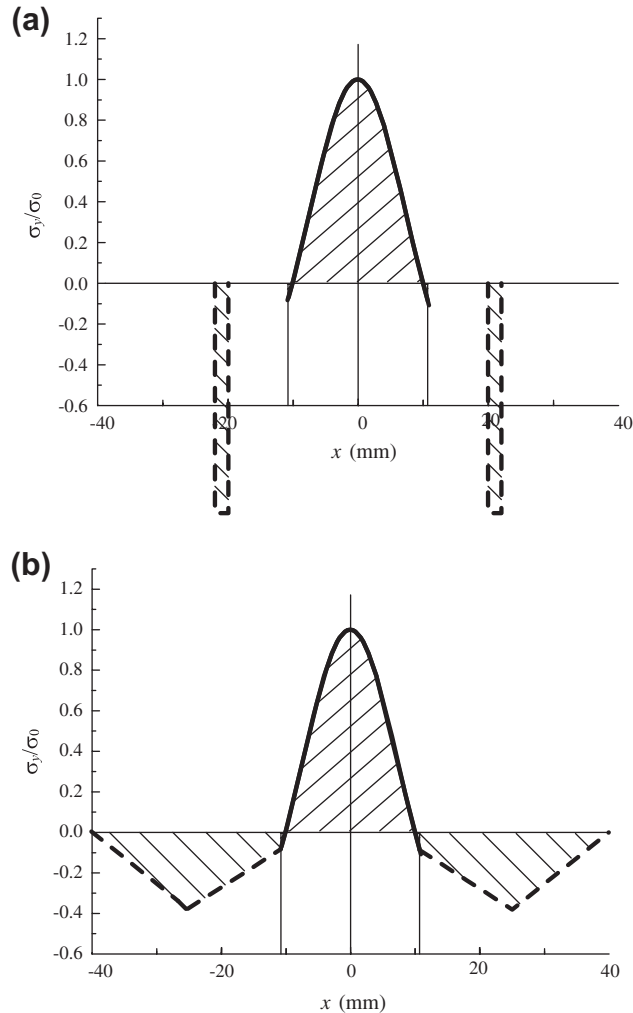

Fig. 8. Artificially balanced residual stresses: (a) with concentrated stress (case 3) and (b) with distributed stress (case 4).

The SIFs can be calculated from the FE solution according to the displacement extrapolation procedure [34] using Eq. (20):

$$K_I = \sqrt{2\pi} \frac{2G}{\kappa + 1} \frac{\Delta u_y}{\sqrt{r}} \tag{20}$$

where Δu_y is the displacement between the two corresponding nodes on the upper and lower crack surfaces, r is the node coordinate. Away from the crack tip, $\Delta u_y/\sqrt{r}$ can be fitted by a linear function of r :

$$\frac{\Delta u_y}{\sqrt{r}} = A + B \cdot r \tag{21}$$

$$\lim_{r \rightarrow 0} \frac{\Delta u_y}{\sqrt{r}} = A \tag{22}$$

Thus,

$$K_I = \sqrt{2\pi} \frac{2GA}{1 + \kappa} \tag{23}$$

The displacement extrapolation needs not to be done manually; the procedure is now implemented in some commercial FE packages and can be executed by calling a corresponding command. For example, in the ANSYS code, the “KCALC” command can be called in the general postprocessor after defining the path. When executing this command, care should be taken to define either the plane stress or plane strain state for a 2D problem. It is recommended to use a refined mesh in the region around the crack tip to capture the rapidly varying stress and deformation fields. The singularity elements at the crack tip mesh will result in more accurate SIF for linear elastic problems. However, the embedded procedure in ANSYS soft package uses the absolute value of the displacement when evaluating SIF via the “KCALC” command, the SIF values calculated by ANSYS will always be positive or zero. If the SIF is evaluated by the energy approach (e.g. the J -integral), then the value will

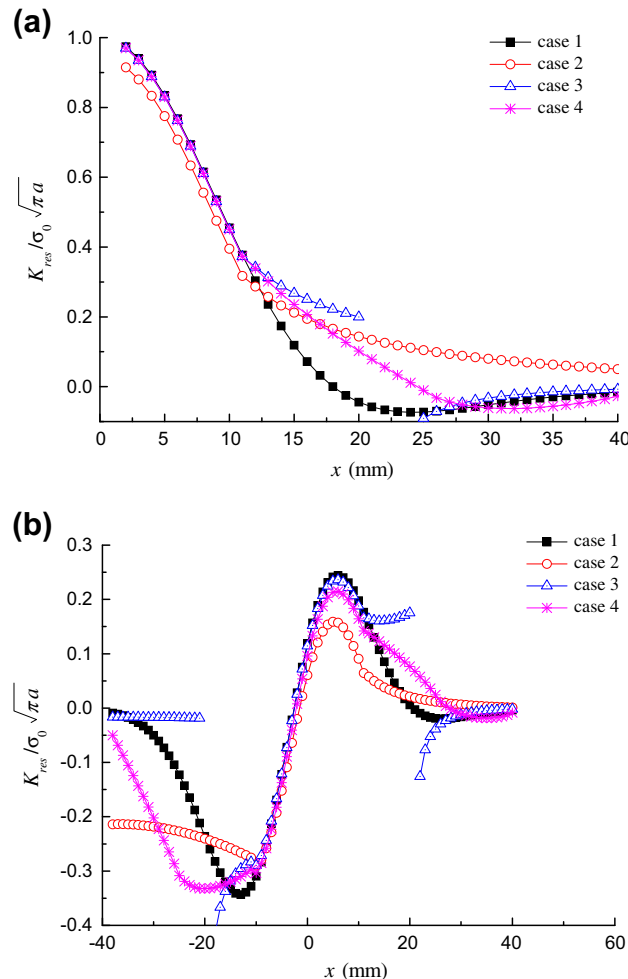

Fig. 9. FE results of K_{res} for cases of different residual stress: (a) centre crack and (b) edge crack.

also be positive or zero. While the influence of residual stresses on the SIF can be either positive or negative as shown in Fig. 5, i.e. K_{res} , which reflects the influence of residual stresses on crack tip stress field, K_{res} is no longer a strict SIF that cannot be negative. To avoid modelling a nonlinear contact problem, we have used the following method. For negative residual stresses, both residual stress and external tension stress are applied to the FE model simultaneously to keep the crack completely open, i.e. $\Delta u_y > 0$ at any position of the crack face. K_{res} is then evaluated based on the superposition principle [35], Eq. (24).

$$K_{res} = K_{tot} - K_{app} \quad (24)$$

3.3. Influence of incomplete residual stresses on K_{res}

As mentioned in Section 2.3, measured residual stresses are usually incomplete and tension dominated, which will result in inaccurate SIF when using the WFM. The same problem exists for using the FEM to evaluate K_{res} . Attempts have been made to balance the initial stresses artificially when inputting them to the FE models. A equilibrium-based least-squares smoothing method was proposed in [36] to obtain full-field residual stress using a set of residual stress data acquired by neutron diffraction over a limited region. Extensive FE calculations are required when using this method. To facilitate simple engineering calculations, two simple cases of artificially balanced stresses are studied in the present paper to demonstrate their influences on the K_{res} . The two geometries used in Section 2.3 and shown in Fig. 4 are used, and set $W = 100$ mm, $c = 10$ mm, $\sigma_0 = 1$ MPa. The K_{res} results from four different initial stresses cases are evaluated. Case 1 is the full-field balanced initial stress $\sigma(x)$ expressed by Eq. (16). Case 2 is the un-balanced case with incomplete $\sigma(x)$ located within $-1.1c \leq x \leq 1.1c$. These two cases are the same as those discussed in Section 2.3 for the WFM and shown in Fig. 4. Cases 3 and 4 are two artificially balanced initial stress distributions shown in Fig. 8 (artificial balancing stresses are plotted by dashed lines). Incomplete ini-

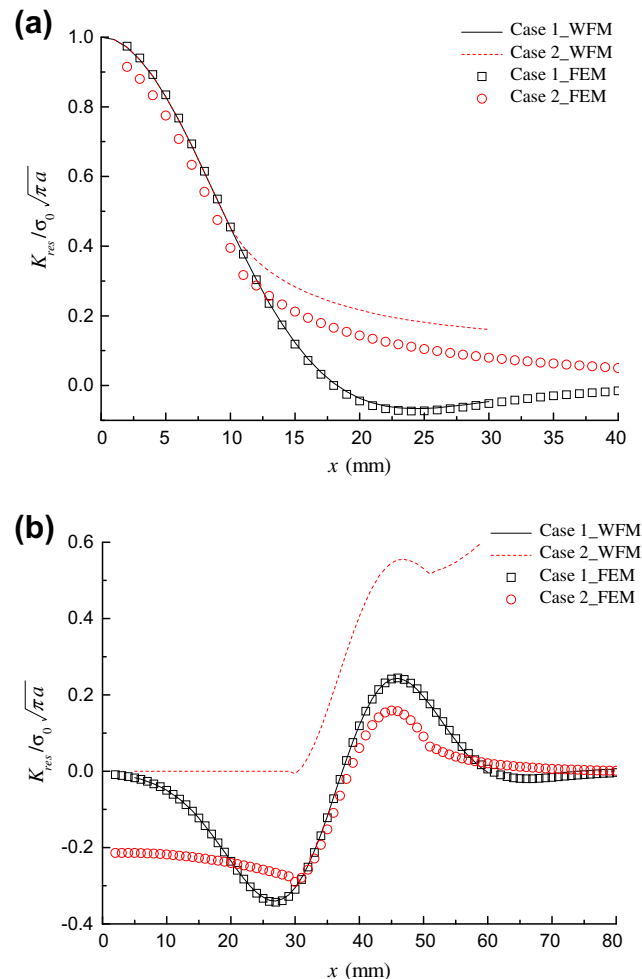

Fig. 10. Comparison of FE and WF results for balanced (case 1) and un-balanced (case 2) residual stresses: (a) center crack and (b) edge crack.

tial stresses are balanced by either concentrated compressive stresses in case 3 or distributed stresses in case 4. Calculated K_{res} values are compared in Fig. 9. It can be said that: (1) For the region where the initial residual stress is known, calculated K_{res} from un-balanced residual stress (case 2) is lower than the K_{res} values calculated from balanced stresses. (2) The artificially balanced initial stress fields give acceptable K_{res} values in the region where initial residual stress is known. (3) For the area where the initial residual stress is unknown, the authentic K_{res} cannot be obtained.

The FE results for the cases 1 and 2 are also compared with the WFM results and shown in Fig. 10. For the area where residual stress is known, it indicates that: (1) For centre crack configuration, the WFM calculated K_{res} for the un-balanced residual stress field is exactly the same as that obtained by the self-balanced initial stress, whereas, the FEM results is 5.8% lower. (2) For the edge crack configuration, the WFM overestimates the K_{res} , whereas, the FEM underestimates the K_{res} if the initial residual stress is un-balanced.

4. Case studies – comparison of WFM and FEM

4.1. VPPA welded AA 2024 M(T) specimen

The Variable Polarity Plasma Arc (VPPA) welding technology has been widely used in the aerospace industry. Residual stress distributions usually show multiple peaks. VPPA welded M(T) and C(T) configurations have been studied by Liljedahl et al. [37] in terms of residual stress measurement and crack growth prediction. These two test sample geometries and measured residual stresses are used in this study to compare the FEM with the WFM. Test samples dimensions are shown in Fig. 11. A measured residual stress distribution for the M(T) configuration was presented in [37] and shown here in Fig. 12a. The residual stress distribution is considered to be symmetric, so it is averaged and mirrored before calculating the K_{res} . For the WFM analysis, residual stress plot was firstly fitted by a multi-peak function, Eq. (25). For the FEM analysis, residual stress profile was artificially balanced (see the dotted lines in Fig. 12a).

$$y(x) = y_0 + \sum_{i=1}^n \frac{A_i}{W_i \sqrt{\pi/2}} e^{-\frac{(x-XC_i)^2}{W_i^2}} \quad (25)$$

where A_i , W_i , and XC_i are fitting parameters, n is the number of peaks.

The K_{res} results obtained by the Wu and Carlsson weight function, Eq. (8), and the FEA are compared in Fig. 12b. It can be seen from Fig. 12b that the WFM and FEM results agree very well to each other when $a < 24$ mm ($a/W < 0.6$). Since the error of Wu's weight function is said to be less than 1% when $a/W \leq 0.5$ [17], when the crack length is much longer ($a/W > 0.6$), FEM gives more accurate evaluation.

4.2. VPPA welded AA 2024 C(T) specimen

For the C(T) geometry, Fig. 11, measured residual stress distribution is taken from [37] and shown here in Fig. 13a. Since the C(T) was cut off from the M(T) specimen, the original residual stress distribution should be the same as the M(T). However, cutting has resulted in stress redistribution and the measured residual stress field in the C(T) specimen is hence asymmetric and compressive at the weld centre contrary to the stresses in the M(T).

The redistribution of residual stress can be evaluated by FE analysis, which is in good agreement with the measured profile and values. The residual stress distribution introduced to the FE model should be the one before the cutting induced redistribution, i.e. the same as the M(T) and then introduce the notch and let the FE to release the stresses for the C(T). For the WFM, the residual stress should be the one without the notch (crack-free stresses). The K_{res} results obtained by the Fett and Munz weight function, Eq. (14), and FE calculation for this geometry are compared in Fig. 13b. Notch tip is at $x = -10$ mm. The WFM and FEM results agree with each other very well. The difference at the beginning (notch tip) is

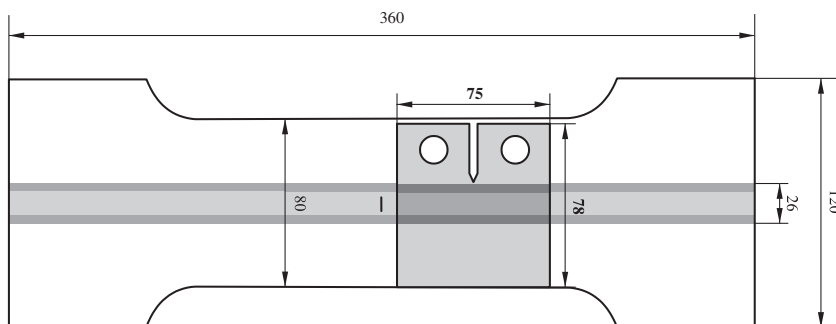

Fig. 11. M(T) and C(T) specimens with a longitudinal VPPA weld; C(T) is cut form an M(T) specimen [37]; unit: mm.

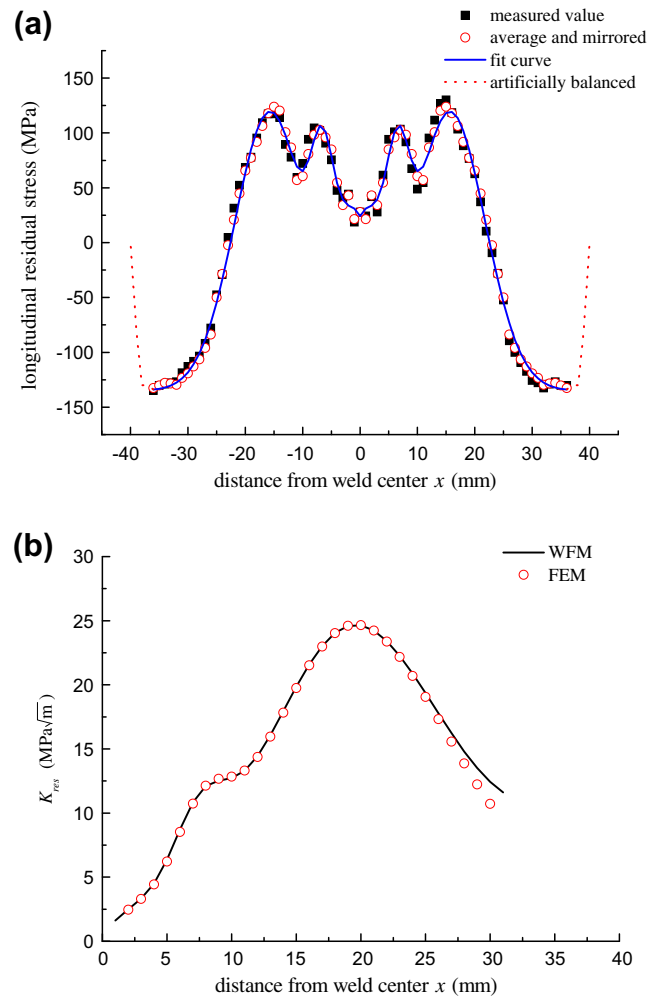

Fig. 12. (a) Longitudinal residual stress distributions and (b) calculated K_{res} in the VPPA welded 2024 M(T) sample.

due to the asymmetric geometry of the C(T). The difference in the final part is due to the inherent limitation of the weight function for longer crack lengths.

4.3. FSW welded AA 2195 ESE(T) specimen

Friction Stir Welding (FSW) is an innovative solid-state welding technique developed for the aerospace applications. Residual stress distribution in the FS welds usually has the character of double peaks. Measured residual stress distribution for eccentrically-loaded single edge crack under tension, ESE(T), geometry was presented in [8], from which the specimen configuration and measured longitudinal residual stress distribution are taken for this study and shown in Figs. 14 and 15a. Residual stress measurement was conducted after cutting the notch, which results in the asymmetric stress profile. Since the initial stress for both the WFM and FEM should be the one without the notch, measured residual stress was mirrored from right to left and fitted by a multi-peak function with five peaks. Calculated K_{res} by the Bueckner's weight function, Eq. (10), and FE result are compared in Fig. 15b. It can be seen that the WFM and FEM results agree with each other when $a/W < 0.6$.

5. Conclusions and recommended calculation procedures

An overview of the WFM and FEM procedures has been performed for evaluating residual stress intensity factors. According to the study described in this paper, especially on the treatment of un-balanced residual stresses, inputting residual

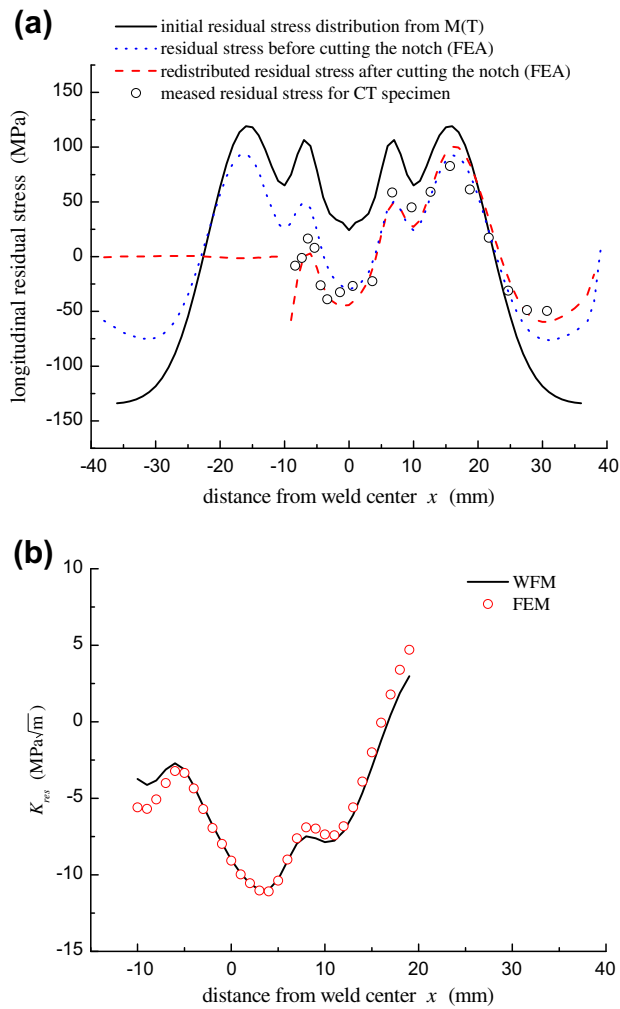

Fig. 13. (a) Residual stress redistribution in the C(T) and (b) calculated K_{res} for the VPPA 2024 C(T) specimen.

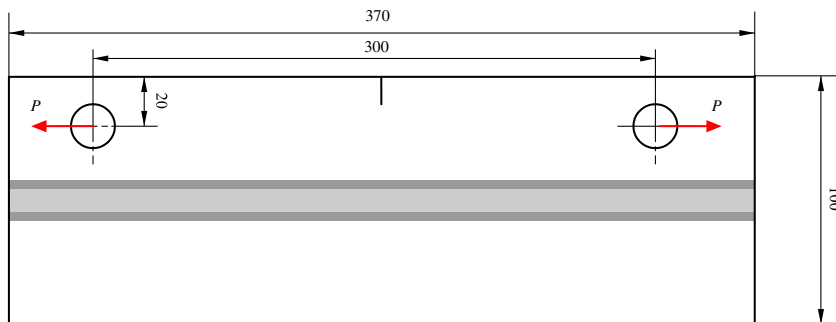

Fig. 14. ESE(T) specimen with longitudinal FSW line; unit: mm.

stresses into FE models and SIF solution of negative residual stresses for the edge crack problem, following conclusions can be drawn:

- (1) For the M(T), C(T) and ESE(T) configurations presented in this paper, residual stress intensity factor solutions obtained by the WFM and FEM agree very well for $a/W < 0.6$. For larger a/W ratio, the difference between the two methods is caused by the inherent limitation of the WFM for longer crack lengths.

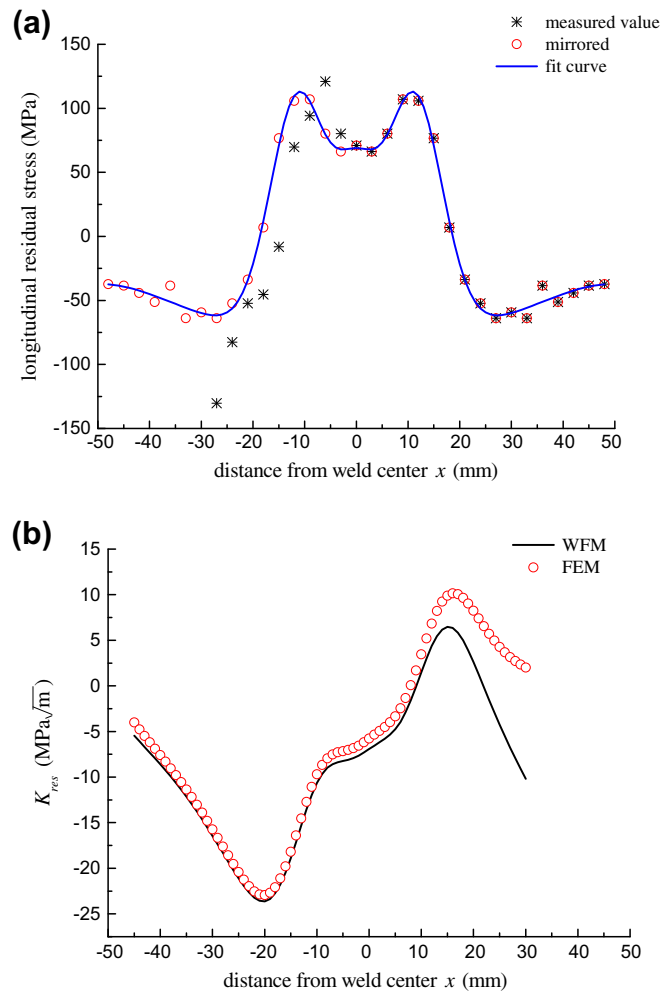

Fig. 15. (a) Residual stress redistributions and (b) calculated K_{res} for the FSW 2195 ESE(T) specimen.

- (2) FE analysis procedures have been developed and validated by well-established weight functions; therefore, the FEM can be employed with confidence for longer crack lengths and for more complex geometries and structures.
- (3) Incomplete residual stress data have significant influence on the K_{res} distribution evaluated by both the WFM and FEM when they are applied to a crack for which the residual stress is known only on a portion of the crack length (for instance an edge crack). If an incomplete measured stress distribution is artificially balanced, then the K_{res} calculated by the FEM is acceptable in the region where the initial residual stresses are known from the measurement.

Following calculation procedures are recommended for the FEM:

- (1) Measured residual stresses should be firstly processed, e.g. averaged, smoothed, fitted and mirrored, etc., before conducting FE analysis to obtain more accurate K_{res} results. This is also recommended for the WFM solution process.
- (2) For incomplete or un-balanced residual stress data, adding artificial balancing stress will help to obtain acceptable K_{res} values in the region where residual stresses are known.
- (3) In order to maintain self-equilibrium condition without any constraints and keep the model boundaries free of stresses, it is necessary to apply the “equilibrium” step in FE packages after inputting measured residual stresses.
- (4) For short-length geometries, higher (than the measured) residual stresses should be inputted into the FE model to accommodate the adjustment in the self-equilibrium step.
- (5) For cracks located in compressive residual stress field, external stress should be applied simultaneously to the residual stress field to make the crack surface completely open for calculating the total SIF. The residual SIF can then be found by the superposition principle.

Acknowledgements

R. Bao is grateful to the China Scholarship Council for supporting her visit to the Cranfield University where this study was performed. N. Ahmad Yahaya acknowledges the Malaysian Government for providing her a scholarship to study at Cranfield.

Appendix A

1. Functions $g_i(a/W)$ in the Kaya–Erdogan weight function for single edge crack problem in a finite width plate, in Eq. (12) [23].

$$g_1\left(\frac{a}{W}\right) = 0.46 + 3.06\left(\frac{a}{W}\right) + 0.84\left(1 + \frac{a}{W}\right)^5 + 0.66\left(\frac{a}{W}\right)^2\left(1 - \frac{a}{W}\right)^2 \tag{A1}$$

$$g_2\left(\frac{a}{W}\right) = -3.52\left(\frac{a}{W}\right)^2 \tag{A2}$$

$$g_3\left(\frac{a}{W}\right) = 6.17 - 28.22\left(\frac{a}{W}\right) + 34.54\left(\frac{a}{W}\right)^2 - 14.39\left(\frac{a}{W}\right)^3 - \left(1 - \frac{a}{W}\right)^{\frac{3}{2}} - 5.88\left(1 - \frac{a}{W}\right)^5 - 2.64\left(\frac{a}{W}\right)^2\left(1 - \frac{a}{W}\right)^2 \tag{A3}$$

$$g_4\left(\frac{a}{W}\right) = -6.63 - 25.16\left(\frac{a}{W}\right) - 31.04\left(\frac{a}{W}\right)^2 + 14.41\left(\frac{a}{W}\right)^3 + 2\left(1 - \frac{a}{W}\right)^{\frac{3}{2}} + 5.04\left(1 - \frac{a}{W}\right)^5 + 1.98\left(\frac{a}{W}\right)^2\left(1 - \frac{a}{W}\right)^2 \tag{A4}$$

- 2. Discrete values of coefficient $\beta_i(a/W)$ in the Wu and Carlsson weight function for single edge crack in a finite width plate in Eq. (13) [17] are given in Table A1.
- 3. Coefficients $A_{v,\mu}$ in the Fett and Munz weight function for C(T) geometry in Eq. (14) [24] are listed in Table A2.
- 4. Discrete values of coefficient $\beta_i(a/W)$ in Wu and Carlsson weight function for the C(T) geometry in Eq. (15) [17] are listed in Table A3.

Table A1
Values of $\beta_i(a/W)$ in Eq. (13).

a/W	β_1	β_2	β_3	β_4	β_5
0.01	2.00	0.9765	1.1420	-0.3504	-0.0912
0.05	2.00	1.0927	1.1506	-0.3662	-0.0819
0.10	2.00	1.4187	1.1378	-0.3550	-0.0763
0.20	2.00	2.5366	1.2378	-0.3474	-0.0562
0.30	2.00	4.2381	1.6796	-0.4095	-0.0188
0.40	2.00	6.6359	2.8048	-0.6105	0.0394
0.50	2.00	10.0222	5.4999	-1.3401	0.2178
0.60	2.00	15.0359	11.8784	-3.6067	0.7858
0.70	2.00	29.5188	45.5066	-18.9281	4.8834
0.80	2.00	38.8128	78.7524	-36.5957	9.8712
0.85	2.00	53.8457	151.2119	-79.0151	22.2696
0.90	2.00	82.6869	350.9961	-207.0916	60.8592

Table A2
 $A_{v,\mu}$ in Eq. (14).

v	$\mu = 0$	1	2	3	4
0	2.673	-8.604	20.621	-14.635	0.477
1	-3.557	24.9726	-53.398	50.707	-11.837
2	1.230	-8.411	16.957	-12.157	-0.940
3	-0.157	0.954	-1.284	-0.393	1.655

Table A3
 $\beta_i(a/W)$ in Eq. (15).

a/W	β_1	β_2	β_3	β_4
0.2	2.0	3.3270	1.4351	-0.4652
0.3	2.0	4.9886	1.7280	-0.4130
0.4	2.0	7.2610	2.7054	-0.4570
0.5	2.0	10.4356	5.2943	-0.7632
0.6	2.0	15.1033	11.3700	-1.6671
0.7	2.0	22.6843	26.0237	-4.0924
0.75	2.0	28.5976	41.2320	-6.7399
0.8	2.0	37.2393	69.1970	-11.7568

References

- [1] Parker AP. Stress intensity factors, crack profiles, and fatigue crack growth rates in residual stress fields. In: Residual stress effects in fatigue. ASTM STP 776. American Society for Testing and Materials; 1982. p. 13–31.
- [2] Itoh YZ, Suruga S, Kashiwaya H. Prediction of fatigue crack growth rate in welding residual stress field. *Engng Fract Mech* 1989;33:397–407.
- [3] Beghini M, Bertini L. Fatigue crack propagation through residual stress fields with closure phenomena. *Engng Fract Mech* 1990;36:379–87.
- [4] Beghini M, Bertini L, Vitale E. Fatigue crack growth in residual stress fields: experimental results and modelling. *Fatigue Fract Engng Mater Struct* 1994;17:1433–44.
- [5] Pouget G, Reynolds AP. Residual stress and microstructure effects on fatigue crack growth in AA2025 friction stir welds. *Int J Fatigue* 2008;30:463–72.
- [6] Fratini L, Pasta S, Reynolds AP. Fatigue crack growth in 2024–T351 friction stir welded joints: longitudinal residual stress and microstructural effects. *Int J Fatigue* 2009;31:495–500.
- [7] Elber W. The significance of fatigue crack closure. Damage tolerance in aircraft structures. ASTM STP 486. American Society for Testing & Materials; 1971. p. 230–42.
- [8] Irving PE, Ma Y, Zhang X, Servetti G, Williams S, Moore G, et al. Control of crack growth rates and crack trajectories in welded aircraft structures. Bridging the gap between theory and operational practice. In: Proceedings of ICAF; 2009. p. 387–405.
- [9] Glinka G, Shen G. Universal features of weight functions for cracks in mode I. *Engng Fract Mech* 1991;40:1135–46.
- [10] Servetti G, Zhang X. Predicting fatigue crack growth rate in a welded butt joint: the role of effective R ratio in accounting for residual stress effect. *Engng Fract Mech* 2009;76:1589–602.
- [11] Labeas G, Diamantakos I. Numerical investigation of through crack behaviour under welding residual stresses. *Engng Fract Mech* 2009;76:1691–702.
- [12] Rooke DP, Baratta FI, Cartwright DJ. Simple methods of determining stress intensity factors. *Engng Fract Mech* 1981;14:397–426.
- [13] Sih GC, Paris PC, Erdogan F. Crack tip stress intensity factors for plane extension and plate bending problem. *J Appl Mech Trans ASME* 1962;29.
- [14] Gunguly S, Fitzpatrick ME, Edwards L. Use of neutron and synchrotron X-ray diffraction for evaluation of residual stresses in a 2024–T351 aluminium alloys variable-polarity plasma-arc weld. *Metal Mater Trans A* 2006;37:411–20.
- [15] Prime MB. Residual stress measurement by successive extension of a slot: the crack compliance method. *Appl Mech Rev* 1999;52:75–96.
- [16] Bao R, Zhang X. An inverse method for evaluating weld residual stresses via fatigue crack growth test data. *Engng Fract Mech*, submitted for publication.
- [17] Wu XR, Carlsson AJ. Weight functions and stress intensity factor solutions. 1st ed. Oxford: Pergamon Press; 1991.
- [18] Shah RC. Stress intensity factors for through and part-through cracks originating at fastener holes. *Mechanics of crack growth*. ASTM STP 590. American Society for Testing & Materials; 1976. p. 429–59.
- [19] Tada H, Paris PC, Irwin GR. The stress analysis of cracks handbook. 2nd ed. St. Louis (Missouri): Paris Publications Incorporated; 1985.
- [20] Sih G. Handbook of stress intensity factors. Bethlehem (Pennsylvania): Institute of Fracture and Solid Mechanics, Lehigh University; 1973.
- [21] Isida M. Stress-intensity factors for the tension of an eccentrically cracked strip. *J Appl Mech* 1966:674–5.
- [22] Bueckner HF. A novel principle for computation of stress intensity factors. *Z Angew Math Mech* 1970;529–46.
- [23] Kaya AC, Erdogan F. Stress intensity factors and COD in an orthotropic strip. *Int J Fract* 1980;16:171–90.
- [24] Fett T, Munz D. Stress intensity factors and weight functions. Southampton: Computational Mechanics Publications; 1997.
- [25] Petroski HJ, Achenbach JD. Computation of weight function from a stress intensity factor. *Engng Fract Mech* 1978;10:257–66.
- [26] Beghini M, Bertini L, Di Lello R, Fontanari V. A general weight function for inclined cracks at sharp V-notches. *Engng Fract Mech* 2007;74:602–11.
- [27] Beghini M, Bertini L, Fontanari V. Stress intensity factors for an inclined edge crack in a semiplane. *Engng Fract Mech* 1999;62:607–13.
- [28] Fett T, Mattheck C, Munz D. Approximate weight function for 2D and 3D-problems. *Engng Anal Boundary Elem* 1989;6:48–63.
- [29] Fett T, Mattheck C, Munz D. On the calculation of crack opening displacement from the stress intensity factor. *Engng Fract Mech* 1987;27:697–715.
- [30] Sha GT, Yang CT. Weight function of radial cracks emanating from a circular hole in a plate. *Fracture Mechanics*. ASTM STP 905. American Society for Testing & Materials; 1986. p. 573–600.
- [31] Tada H, Paris PC, Irwin GR. The stress analysis of cracks handbook. 3rd ed. New York: The American Society of Mechanical Engineers; 2000.
- [32] ABAQUS user/technical manual version 6.5. Hibbit, Karlsson and Sorensen Inc.; 2005.
- [33] Documentation for ANSYS Release 11.0. ANSYS Inc.; 2007.
- [34] Lei Y, O'Dowd NP, Webster GA. Fracture mechanics analysis of a crack in a residual stress field. *Int J Fract* 2000;106:195–216.
- [35] Anderson TL. Fracture mechanics, fundamentals and applications. 3rd ed. Norway: CRC Press, Taylor and Francis Group; 2005.
- [36] Ge YZ, Sutton MA, Deng X, Reynolds AP. Limited weld residual stress measurements in fatigue crack propagation: Part I. Complete field representation through least-squares finite-element smoothing. *Fatigue Fract Engng Mater Struct* 2006;29:524–36.
- [37] Liljedahl CDM, Brouard J, Zanellato O, Lin J, Tan ML, Ganguly S, et al. Weld residual stress effects on fatigue crack growth behaviour of aluminium alloy 2024–T351. *Int J Fatigue* 2009;31:1081–8.